



SCHACKER REALTY

## 42,000 sq. ft. of Industrial/R&D Space For Lease

Minimum Division 10,000 sq. ft.

**700 Hicksville Rd, Bethpage**



### Specifications:

**Building Size:** 700,000 sq. ft.  
**Lot Size:** 15.00 Acres  
**Office Space:** 10,000 sq. ft.  
**Ceiling Height:** 16.0'  
**Loading:** 1 Dock(s), 1 Drive-in(s)  
**A/C:** Full A/C  
**Parking:** Excellent  
**Sewers:** Yes

### Pricing and Timing:

**Occupancy:** Immediately  
**Lease Price:** Negotiable

**Suite 100 • 42,000 sf industrial space with 10,000 sf of dedicated office space • Space in excellent condition • More docks/doors can be added • Includes kitchen area and plenty of natural light • Only 20 minures form the Queens border**

**For more information please contact:** Schacker Realty 631-293-3700 [info@schackerrealty.com](mailto:info@schackerrealty.com)

All information is subject to errors, omissions, modification, and withdrawal.

Measurements may be estimates and information shown should not be relied upon without independent verification.

This advertisement does not suggest that the broker has a listing or has done a transaction in this property or properties.



SCHACKER REALTY

700 Hicksville Rd, Bethpage

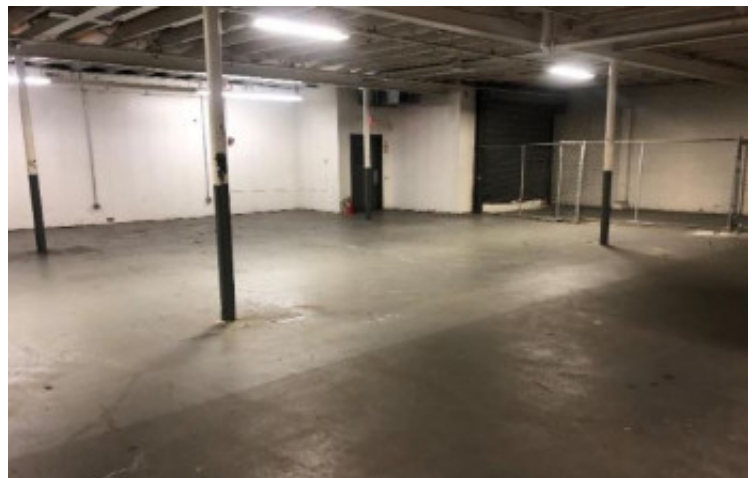

**For more information please contact:** Schacker Realty 631-293-3700 [info@schackerrealty.com](mailto:info@schackerrealty.com)

All information is subject to errors, omissions, modification, and withdrawal.

Measurements may be estimates and information shown should not be relied upon without independent verification.

This advertisement does not suggest that the broker has a listing or has done a transaction in this property or properties.

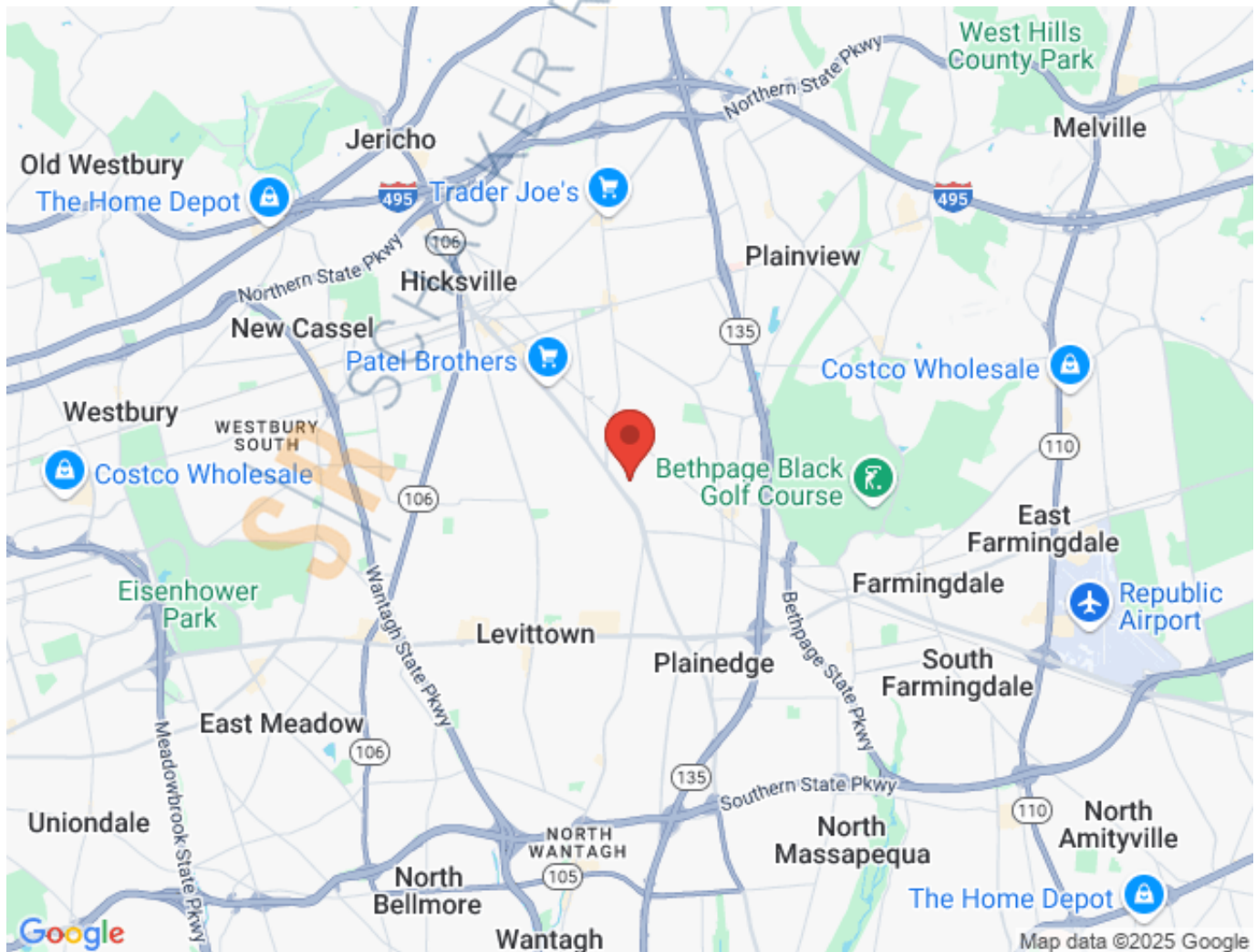

**For more information please contact:** Schacker Realty 631-293-3700 [info@schackerrealty.com](mailto:info@schackerrealty.com)

All information is subject to errors, omissions, modification, and withdrawal.

Measurements may be estimates and information shown should not be relied upon without independent verification.

This advertisement does not suggest that the broker has a listing or has done a transaction in this property or properties.

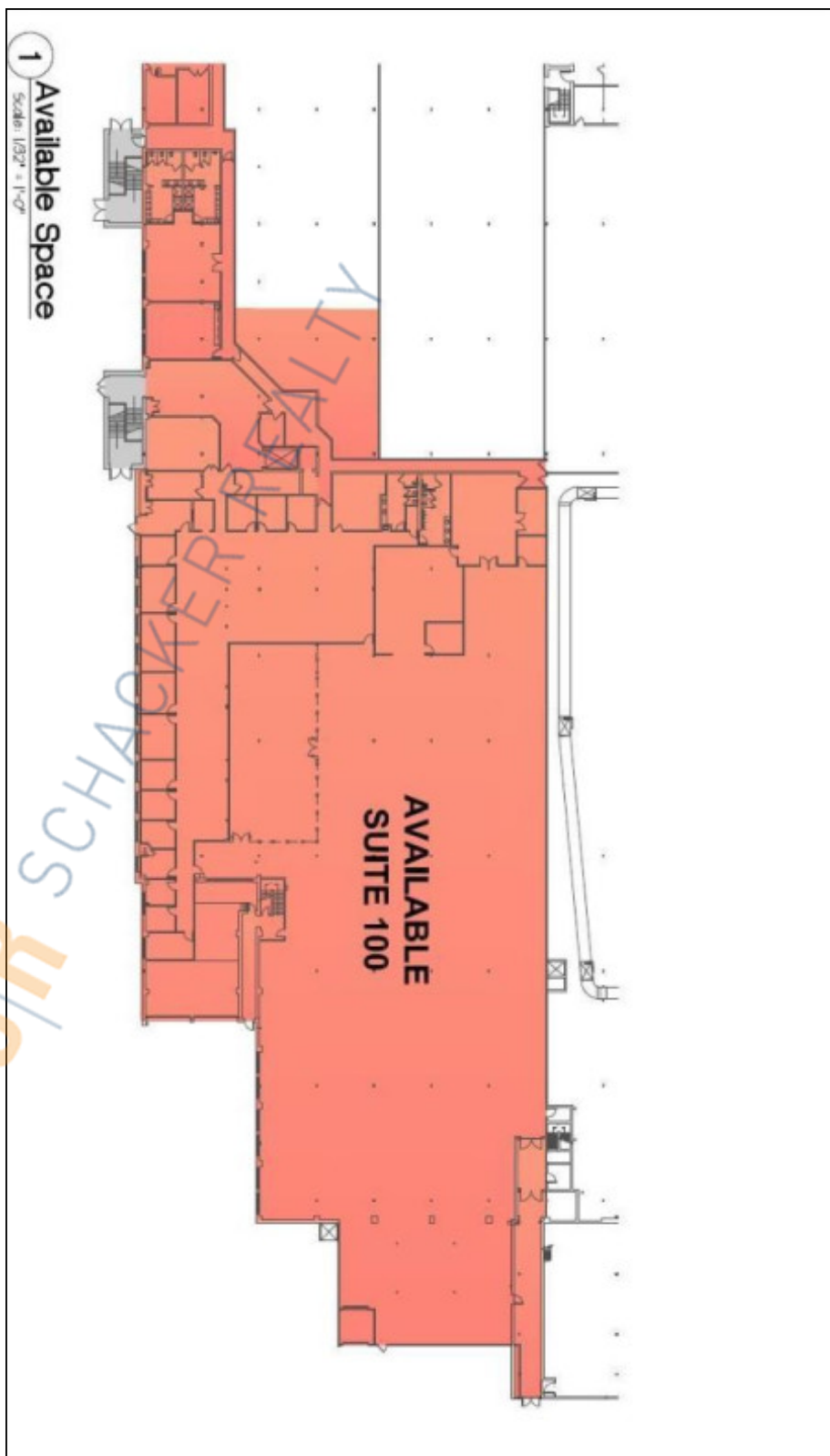

**For more information please contact:** Schacker Realty 631-293-3700 [info@schackerrealty.com](mailto:info@schackerrealty.com)

All information is subject to errors, omissions, modification, and withdrawal.

Measurements may be estimates and information shown should not be relied upon without independent verification.

This advertisement does not suggest that the broker has a listing or has done a transaction in this property or properties.



SCHACKER REALTY

700 Hicksville Rd, Bethpage



**For more information please contact:** Schacker Realty 631-293-3700 [info@schackerrealty.com](mailto:info@schackerrealty.com)

All information is subject to errors, omissions, modification, and withdrawal.

Measurements may be estimates and information shown should not be relied upon without independent verification.

This advertisement does not suggest that the broker has a listing or has done a transaction in this property or properties.



**For more information please contact:** Schacker Realty 631-293-3700 [info@schackerrealty.com](mailto:info@schackerrealty.com)

All information is subject to errors, omissions, modification, and withdrawal.

Measurements may be estimates and information shown should not be relied upon without independent verification.

This advertisement does not suggest that the broker has a listing or has done a transaction in this property or properties.