



SCHACKER REALTY

42,904 sq. ft. of Industrial Space For Lease

205 E 2nd St, Mineola



Specifications:

Building Size: 42,904 sq. ft.
Lot Size: 0.38 Acres
Office Space: 5% BTS
Ceiling Height 1: 26.6' @ 15,780 sq. ft.
Ceiling Height 2: 15.9' @ 2,429 sq. ft.
Loading: 2 Dock(s)
Power: 1,200 amps
Parking: 12
Sewers: Yes

Pricing and Timing:

Occupancy: Immediately
Lease Price: Negotiable

Building has multiple ceiling heights • 12,391sf mezzanine included in building sq. footage •
BTS office space (5%) • Mezzanine has

For more information please contact: Schacker Realty 631-293-3700 info@schackerrealty.com

All information is subject to errors, omissions, modification, and withdrawal.

Measurements may be estimates and information shown should not be relied upon without independent verification.

This advertisement does not suggest that the broker has a listing or has done a transaction in this property or properties.



SCHACKER REALTY

205 E 2nd St, Mineola



For more information please contact: Schacker Realty 631-293-3700 info@schackerrealty.com

All information is subject to errors, omissions, modification, and withdrawal.

Measurements may be estimates and information shown should not be relied upon without independent verification.

This advertisement does not suggest that the broker has a listing or has done a transaction in this property or properties.

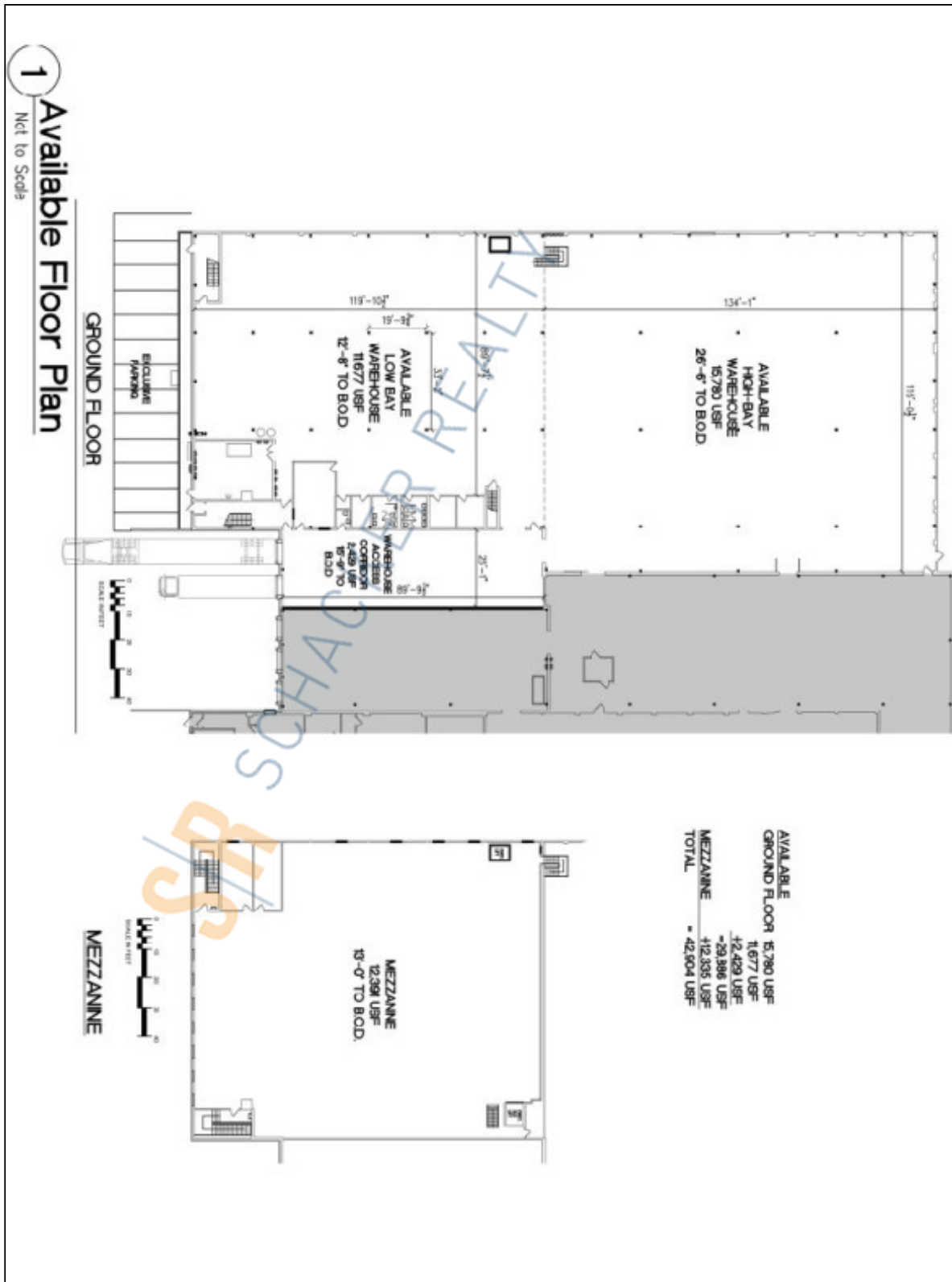

For more information please contact: Schacker Realty 631-293-3700 info@schackerrealty.com

All information is subject to errors, omissions, modification, and withdrawal.

Measurements may be estimates and information shown should not be relied upon without independent verification.

This advertisement does not suggest that the broker has a listing or has done a transaction in this property or properties.