



SCHACKER REALTY

57,776 sq. ft. of Ind/Office/R&D Space For Lease 600 W John St, Hicksville



Specifications:

Building Size: 216,945 sq. ft.
Lot Size: 8.60 Acres
Office Space: 10%
Ceiling Height 1: 14.0' @ 31,000 sq. ft.
Ceiling Height 2: 13.0' @ 57,776 sq. ft.
Loading: 2 Dock(s), 2 Drive-in(s)
Power: Heavy amps
Parking: 200+
Sewers: Yes

Pricing and Timing:

Occupancy: Spring 2024
Lease Price: \$18.00/sq. ft. Includes Taxes & CAM

Suite 200 • 31,000/sf 1st floor warehouse space • 57,776/sf elevator served 2nd floor flex/office space above 1st floor space with abundant natural light. • Ample parking • Excellent parking • +_1.3 miles to Hicksville train station less than 5 minute drive to Long Island Expwy.

For more information please contact: Schacker Realty 631-293-3700 info@schackerrealty.com

All information is subject to errors, omissions, modification, and withdrawal.

Measurements may be estimates and information shown should not be relied upon without independent verification.

This advertisement does not suggest that the broker has a listing or has done a transaction in this property or properties.



SCHACKER REALTY

600 W John St, Hicksville

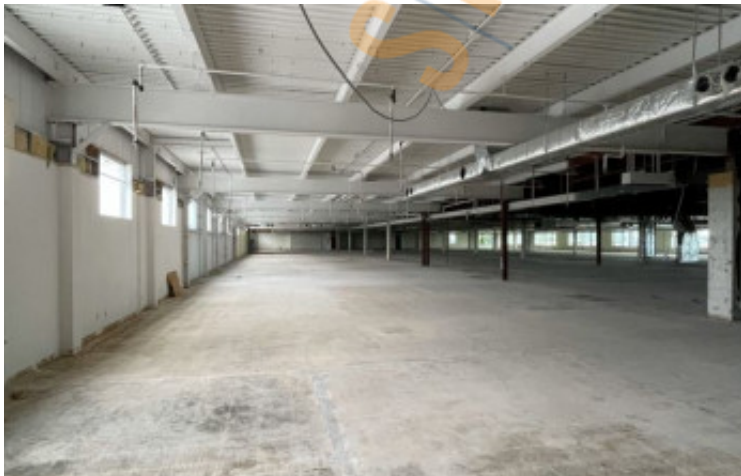

For more information please contact: Schacker Realty 631-293-3700 info@schackerrealty.com

All information is subject to errors, omissions, modification, and withdrawal.

Measurements may be estimates and information shown should not be relied upon without independent verification.

This advertisement does not suggest that the broker has a listing or has done a transaction in this property or properties.



SCHACKER REALTY

600 W John St, Hicksville

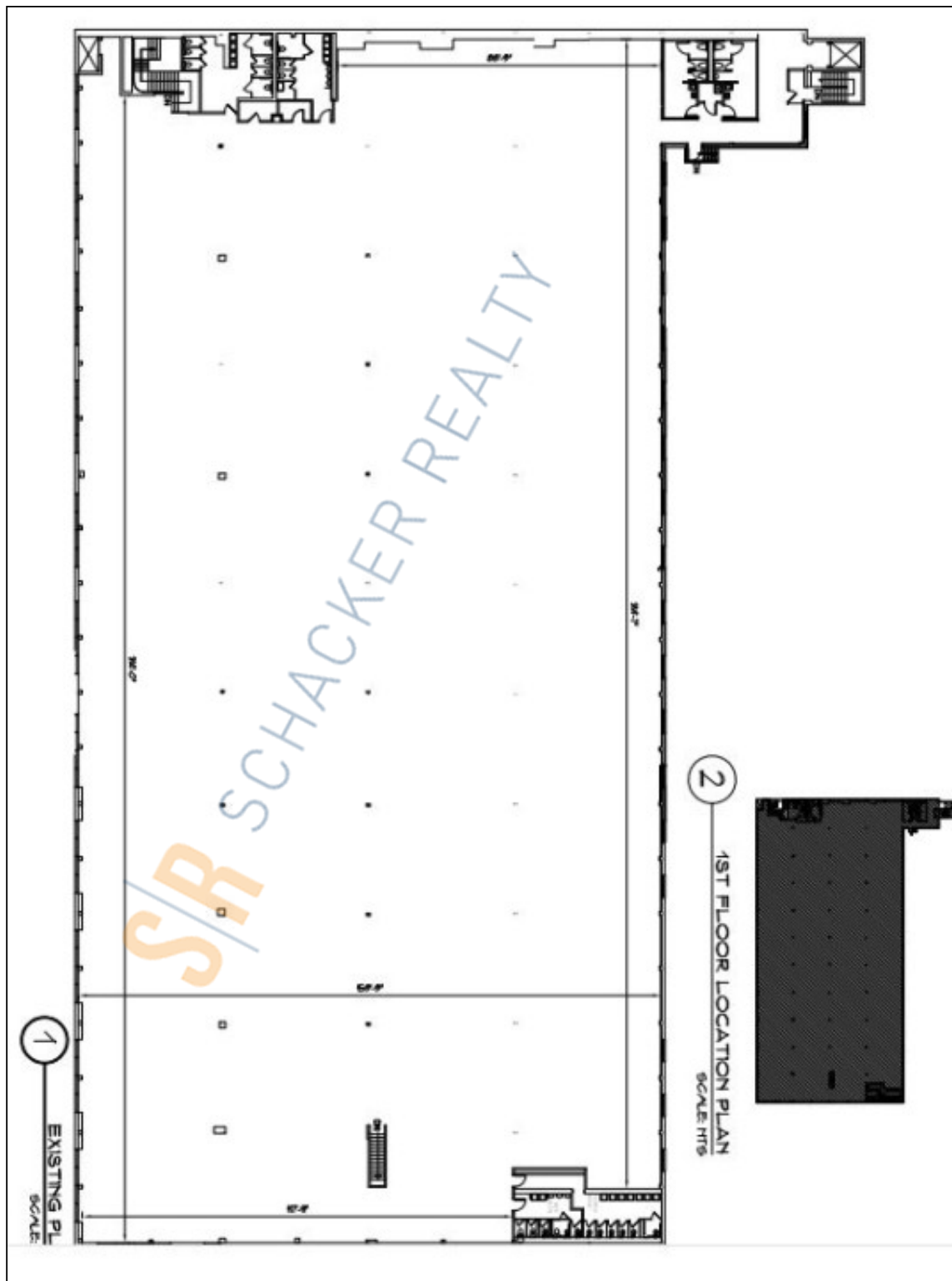

For more information please contact: Schacker Realty 631-293-3700 info@schackerrealty.com

All information is subject to errors, omissions, modification, and withdrawal.

Measurements may be estimates and information shown should not be relied upon without independent verification.

This advertisement does not suggest that the broker has a listing or has done a transaction in this property or properties.

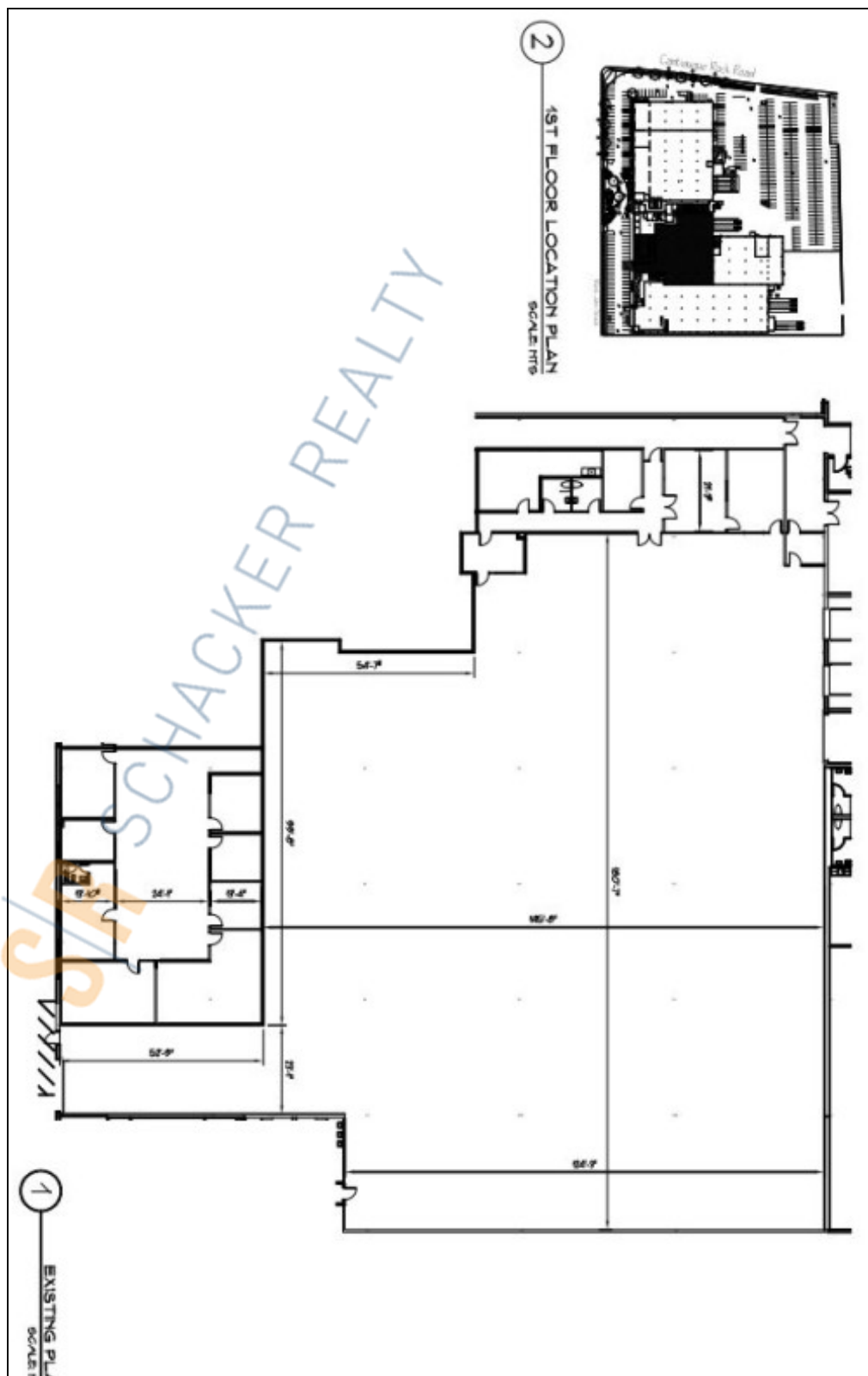

For more information please contact: Schacker Realty 631-293-3700 info@schackerrealty.com

All information is subject to errors, omissions, modification, and withdrawal.

Measurements may be estimates and information shown should not be relied upon without independent verification.

This advertisement does not suggest that the broker has a listing or has done a transaction in this property or properties.