



SCHACKER REALTY

12,000 sq. ft. of Office/Retail/Industrial Space For Lease 45 S Service Rd, Plainview



Specifications:

Lot Size: 6.70 Acres
Ceiling Height 1: 18.0'
Ceiling Height 2: 15.0'
Loading: 1 Dock(s)
Power: ample amps
A/C: Full A/C
Parking: 4:1
Sewers: Yes

Pricing and Timing:

Occupancy: Vacant
Lease Price: \$30.00/sq. ft. Gross

Suite 12000 • Former auto dealership in newly renovated building • Located in the heart of Long Island • Neighboring several prestigious tenants • Minutes from Nassau/Suffolk border • 35 miles from New York City

For more information please contact: Schacker Realty 631-293-3700 info@schackerrealty.com

All information is subject to errors, omissions, modification, and withdrawal.

Measurements may be estimates and information shown should not be relied upon without independent verification.

This advertisement does not suggest that the broker has a listing or has done a transaction in this property or properties.



SCHACKER REALTY

45 S Service Rd, Plainview

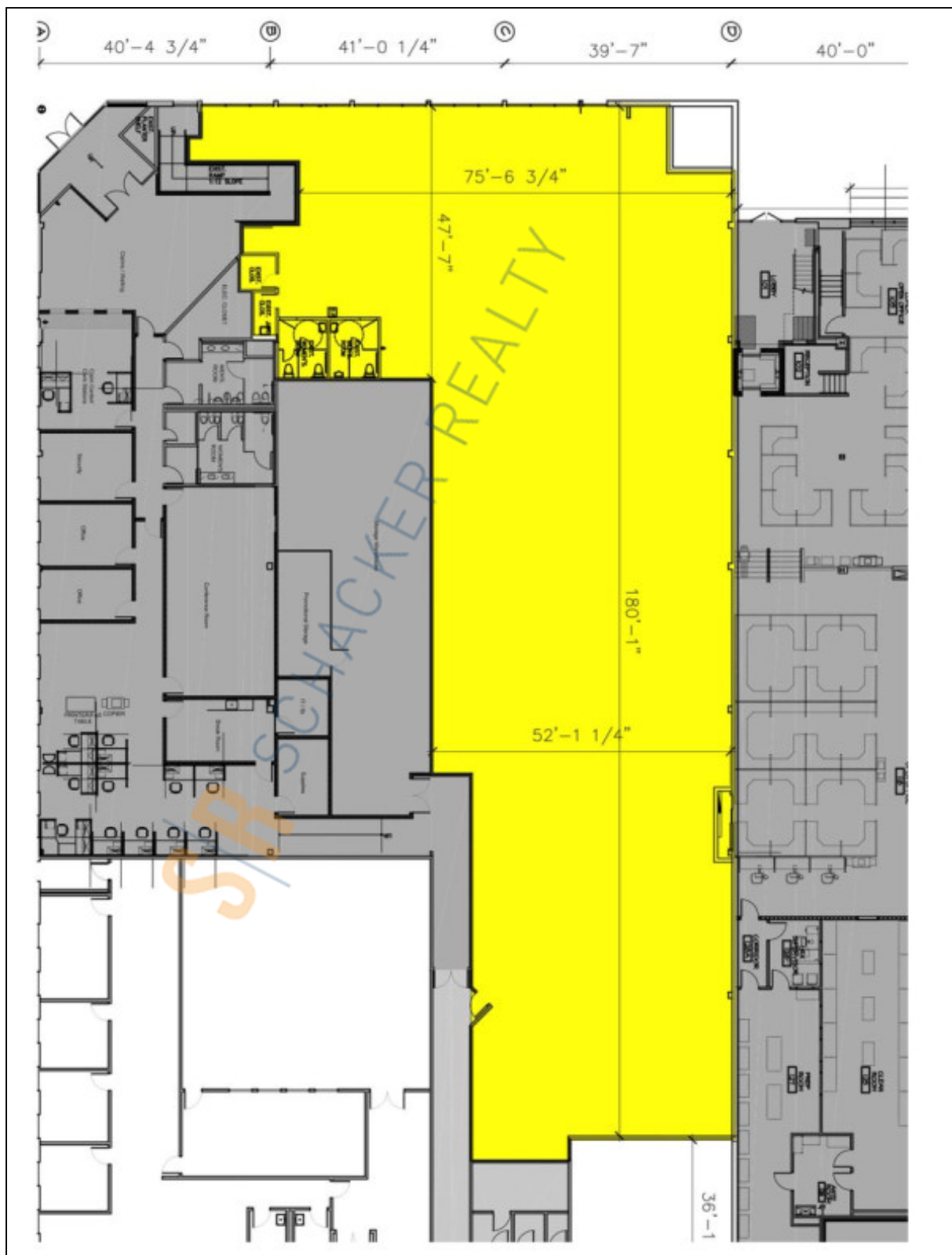

For more information please contact: Schacker Realty 631-293-3700 info@schackerrealty.com

All information is subject to errors, omissions, modification, and withdrawal.

Measurements may be estimates and information shown should not be relied upon without independent verification.

This advertisement does not suggest that the broker has a listing or has done a transaction in this property or properties.



SCHACKER REALTY

45 S Service Rd, Plainview



For more information please contact: Schacker Realty 631-293-3700 info@schackerrealty.com

All information is subject to errors, omissions, modification, and withdrawal.

Measurements may be estimates and information shown should not be relied upon without independent verification.

This advertisement does not suggest that the broker has a listing or has done a transaction in this property or properties.